



BL7158 LED 3W

Applications

LED mini-accent light with multiple beam patterns and retractable shrouds, 360° rotatable and 180° tiltable, ideally suited for highlighting small objects or small target surfaces. Diminutive dimensions and choices of mounting accessories allow unobtrusive placement on wall surfaces, lawns and trees.

Dimensions

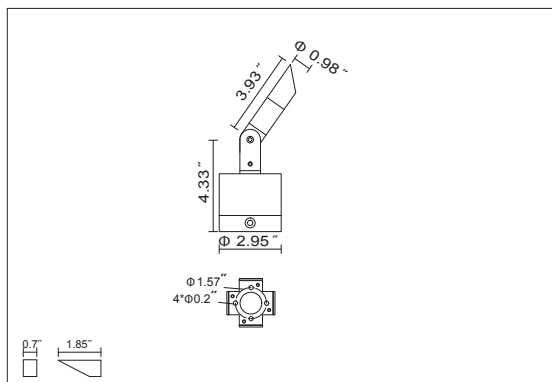

Specifications

| | |
|---------------------|---|
| Housing | Die-cast aluminum |
| Gasket | Silicone rubber |
| Front Cover | Tempered Glass |
| LED Optic | Polycarbonate Lens |
| Surface Finish | AkzoNobel powder coating |
| Driver Type | Constant current |
| Input Voltage | 100~277V/AC |
| Ambient Temperature | -20°C~45°C |
| Ingress Protection | IP65 |
| Certifications |  |

Options and Accessories

Shroud



No shroud



Angled shroud

Housing Color



Black RAL9011 White RAL9016 Gray RAL7012 Mineral bronze Silver RAL9006



Horizontal spread
H35°xV15°



Vertical spread
H15°xV35°



Tree strap



Ground Stake



Ground Mount
(standard)



Wall Mount
(standard)



Ground stake

Ordering Guide:

Example: BL7158 - C3 - 4 - 15 - 80 - AS - B - S

| 1 Series | 2 Power | 3 CCT | 4 Beam angle | 5 Ra | 6 Shroud | 7 Housing Color | 8 Accessories |
|----------|-----------|----------------------------------|---|----------|------------------------------------|---|--|
| BL7158 | C3:LED 3W | 3: 3000K 4: 4000K 6: 6000K | 08: 8° 15: 15° 25: 25° 40: 40° AH: H35°xV15° AV: H15°xV35° | 80: Ra80 | NS: No shroud AS: Angled shroud | B: Black RAL9011 W: White RAL9016 G: Gray RAL7012 Z: Mineral bronze S: Silver RAL9006 | S: Ground Stake P: Tree strap M: Marine ambient corrosion resistance |



AN AMERICAN COMPANY